

Stage 2; 14 X lifting tracks

NOTE:  
- ALL DIMENSIONS ARE TO STUDS AND/OR CONCRETE BLOCKS EXCLUDING FURRING CHANNELS AND LINING.  
- REFER TO PARTITIONS TYPES FOR FURRING CHANNELS AND LINING.  
- SIZES TO FURRING CHANNELS ARE VARIES FROM 16, 38 OR 50MM STUDS TO SUIT UNLESS OTHERWISE NOTED.

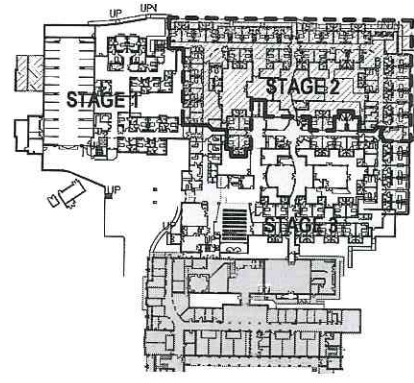

rev.	date	details	pa.inl
191911	For Construction		17

# FLOOR PLAN LEGEND

NOTE: NOT ALL ITEMS USED IN THIS PROJECT

- BOL BOLLARD
- CG CORNER GUARD
- HR HANDRAIL
- BS BALUSTRADE
- CJ CONSTRUCTION JOINT
- COL COLUMN
- DP DOWNPIPE
- FE FIRE EXTINGUISHER
- FW FLOOR WASTE
- GD GRATED DRAIN

## DOOR SYMBOL

NOTE: FLOOR LEVEL/STAGE-DOOR NO

- DOOR TYPE

## WINDOW SYMBOL

NOTE: WINDOW TYPE

## WALL TYPES LEGEND

NOTE: NOT ALL WALL TYPES USED IN THIS PROJECT

WALLS WITH MULTIPLE LAYERS SHOW EXTERNAL SIDE AT TOP

ACTUAL WIDTHS SHOWN AFTER MATERIAL

- EXISTING WALL

- 250 BRICK VENEER 110/50/92

- 300 BRICK/BLOCK VENEER 110/50/140

- 300 DOUBLE BRICK CAVITY 110/80/110

- 150 SERIES BLOCKWORK 140

- 100 SERIES BLOCKWORK 90

- 90 TIMBER STUD

- FIRE WALL: 140 CORE FILLED BLOCKWORK

- FIRE WALL: TIMBER STUD-2 LAYERS 10mm PYROCHECK BOTH SIDES TO ROOF

- SMOKE WALL: 13mm PLASTERBOARD BOTH SIDES TO UNDERSIDE ROOF

## FLOOR FINISHES LEGEND

NOTE: NOT ALL ITEMS USED IN THIS PROJECT

- CA CARPET

- CO CONCRETE

- EM ENTRY MAT (Recessed)

- SRV SLIP RESISTANT VINYL

- SV SHEET VINYL

- SV2 SHEET VINYL

- T TILE

ThomsonAdsett accept no responsibility for the usability, completeness or accuracy of data transferred electronically. Recipients should when necessary request a hard copy version for verification. Use imperial dimensions in preference to metric. All dimensions to be verified on site.

Copyright

These drawings and designs and the copyright thereof are the property of ThomsonAdsett (Victoria) Pty Ltd and must not be used, retained or copied without the written permission of ThomsonAdsett (Victoria) Pty Ltd.

A.B.N. 70 163 314 627

Trading as THOMSONADSETT.

**ThomsonAdsett**

Level 1  
242 Dorcas Street  
South Melbourne  
VIC 3205  
Phone: (03) 9699 6116  
Fax: (03) 9699 6171  
Email: msa@thomsonadsett.com  
www.thomsonadsett.com

project  
**Assisi Centre  
Redevelopment**

230 Rosanna Rd,  
Rosanna VIC 3084

Burns Bridge Australia  
client  
Ground Floor Plan - Stage 2

sheet	date: 16 March 2011
scale: As indicated	draw: YK/BA
checked: FF	verified: DJ
7070C project no.	A204 C1 sheet no.

FOR CONSTRUCTION

1771 (2011) 12/26 37 001